

# Corner Construction Wall Specifications

Lead Backed Plywood

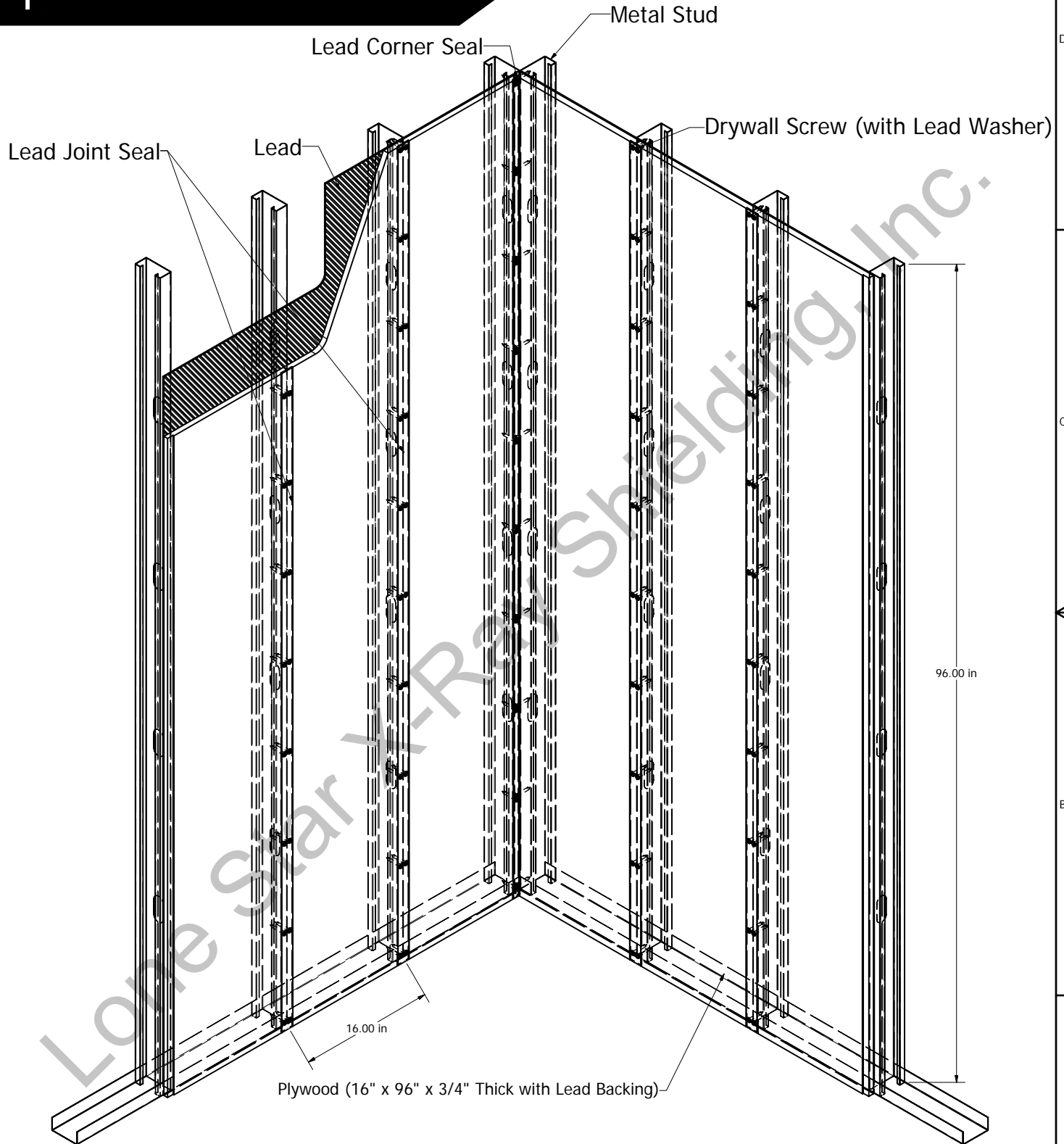

Fire Rated Plywood Specification	DRAWN	4/23/2009	LONE STAR XRAY SHIELDING	
	CHECKED		TITLE	
Tested under the following specifications: ASTMD-5664, ASTMD-5516, & Report #457.	QA		Lead Backed Plywood Assembly	
	MFG		SIZE	DWG NO
	APPROVED		C	Plywood to Studs Assembly
	Lead Thickness Per Customer Spec	0.0313" - 0.125"	SCALE	REV
			015:1	Unhidden
				SHEET 1 OF 1